



Ballards Lane, Finchley Central, N3

£850 pcm

 1 Bedroom  1 Bathroom  1 Reception



North Finchley Office

365 Ballards Lane, North Finchley, London, N12 8LL

Tel: 020 8445 4008 Email: info@adam-hayes.co.uk Web: www.adam-hayes.co.uk

Ballards Lane, Finchley Central, N3

£850 pcm

 1 Bedroom  1 Bathroom  1 Reception

Key Features

- Modern Studio Flat
- Inclusive of Water Rates
- Close to Tube
- Separate Modern Kitchen
- Laminated Wooden Flooring
- Double Glazing

Nearest Stations

Finchley Central - (0.3 mi)

West Finchley - (0.4 mi)

Mill Hill East - (0.9 mi)

Property Description

A modern studio flat inclusive of water rates situated above a commercial premises within easy access of Finchley Central Tube Station (Northern Line) and local shops and amenities. The property benefits from a separate modern fitted kitchen, modern bathroom, laminated wooden flooring, spot lights, double glazing and gas central heating. Early viewings are highly recommended!

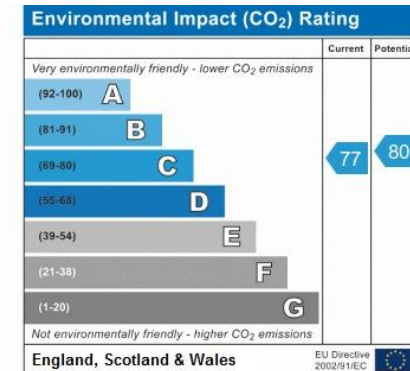
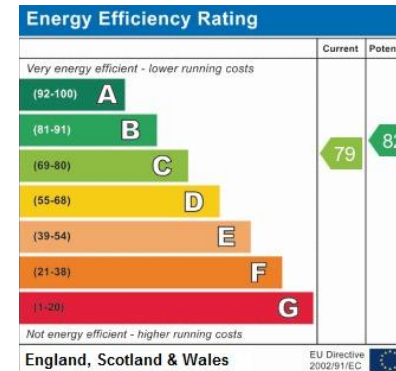

North Finchley Office

365 Ballard's Lane, North Finchley, London, N12 8LL

Tel: 020 8445 4008 Email: info@adam-hayes.co.uk Web: www.adam-hayes.co.uk

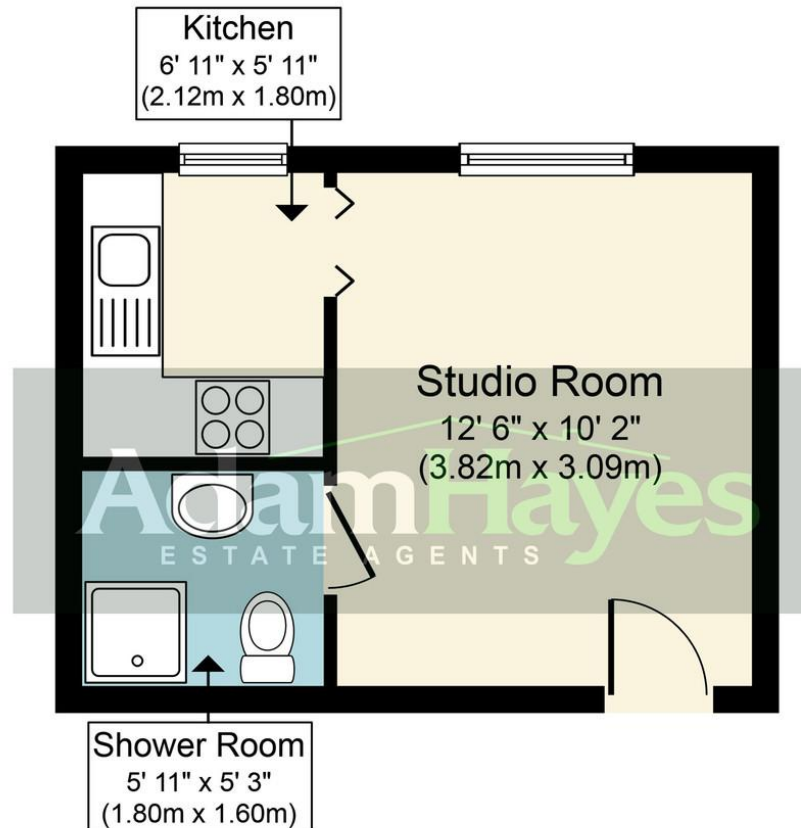

Approximate Floor Area
206 sq. ft.
(19.1 sq. m.)

Approx. Gross Internal Floor Area 206 sq. ft. / 19.1 sq. m.

Whilst every attempt has been made to ensure the accuracy of the floor plan contained here, measurements of doors, windows, rooms and any other items are approximate and no responsibility is taken for any error, omission, or mis-statement. This plan is for illustrative purposes only and should be used as such by any prospective purchaser or tenant. The services, systems and appliances shown have not been tested and no guarantee as to their operability or efficiency can be given.
Copyright V360 Ltd 2017 | www.houseviz.com

These particulars, whilst believed to be accurate, are set out as a general outline only for guidance and do not constitute any part of an offer or contract. Intending purchasers or prospective tenants should not rely on them as statements or representation of fact, but must satisfy themselves by inspection or otherwise as to their accuracy. We have not carried out a detailed survey, not tested the services, appliances and specific fittings. Room sizes should not be relied upon for carpets and furnishings. The measurements given are approximate. No person in this firm's employment has the authority to make or give any representation or warranty in respect of the property.