



Adam Hayes

Cardrew Close, North Finchley, N12

OIEO £450,000

 3 Bedrooms  1 Bathrooms  1 Receptions

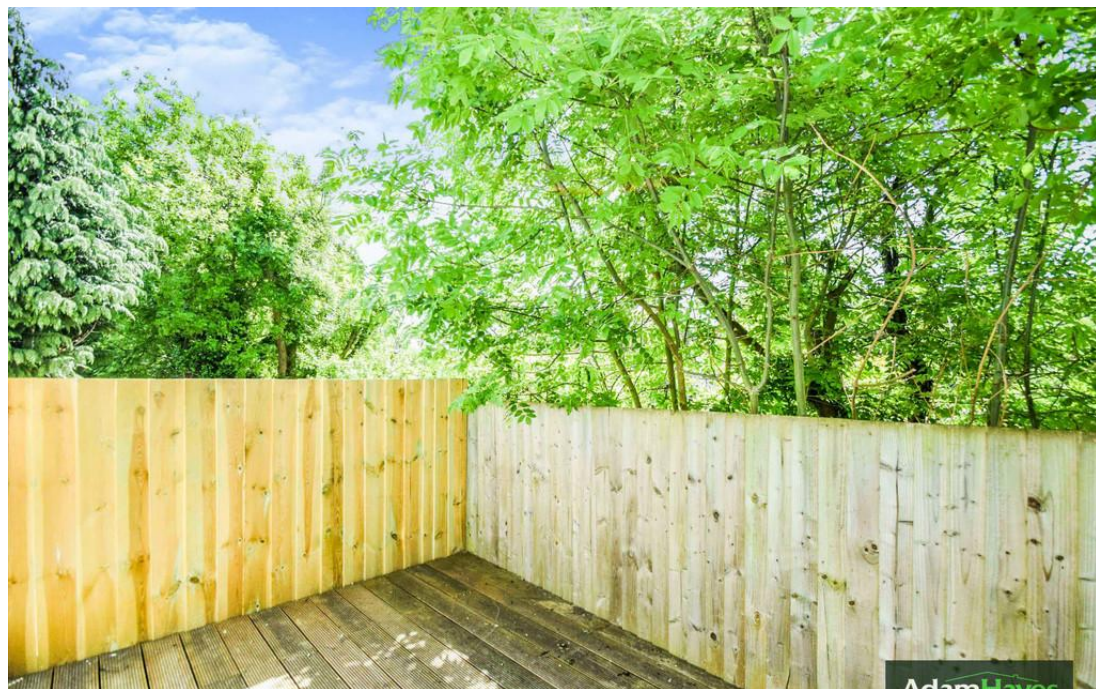

North Finchley Office

365 Ballards Lane, North Finchley, London, N12 8LL

Tel: 020 8445 4008 Email: info@adam-hayes.co.uk Web: www.adam-hayes.co.uk

Cardrew Close, North Finchley, N12

OIEO £450,000

 3 Bedrooms  1 Bathrooms  1 Receptions

Key Features

- Three Bedrooms
- Ground Floor Maisonette
- Recently Refurbished
- Chain Free
- Modern Kitchen
- Garden

Nearest Stations

Woodside Park (0.8 miles)

West Finchley (1 mile)

New Southgate (1 mile)

Property Description

Situated in this residential turning off Friern Park and within minutes' walk to Friary Park is this RECENTLY REFURBISHED AND EXTENDED THREE BEDROOM GROUND FLOOR MAISONETTE. The property is offered CHAIN FREE and has been finished to a high standard. Benefitting from a modern kitchen and shower room, wooden flooring, direct access to patio and an additional garden. However to really appreciate the size, location and condition an internal viewing is highly recommended via vendors sole agents Adam Hayes Estate Agents on 020 8445 4008.

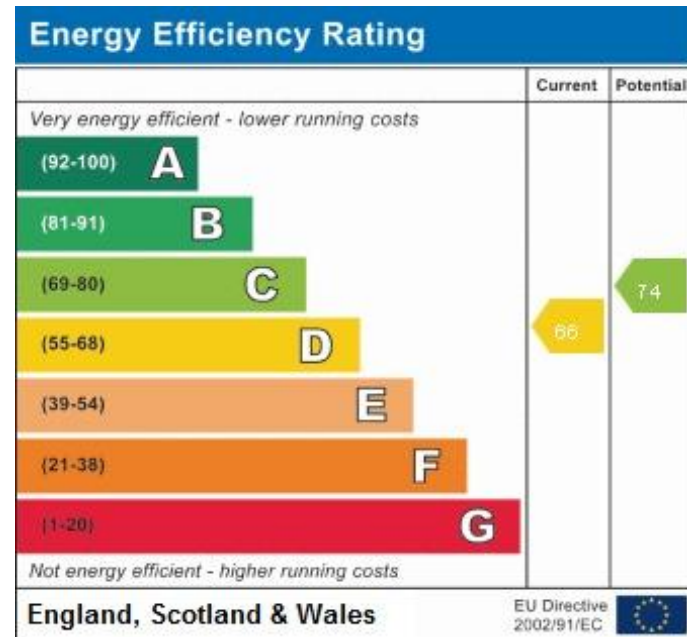

North Finchley Office

365 Ballards Lane, North Finchley, London, N12 8LL

Tel: 020 8445 4008 Email: info@adam-hayes.co.uk Web: www.adam-hayes.co.uk

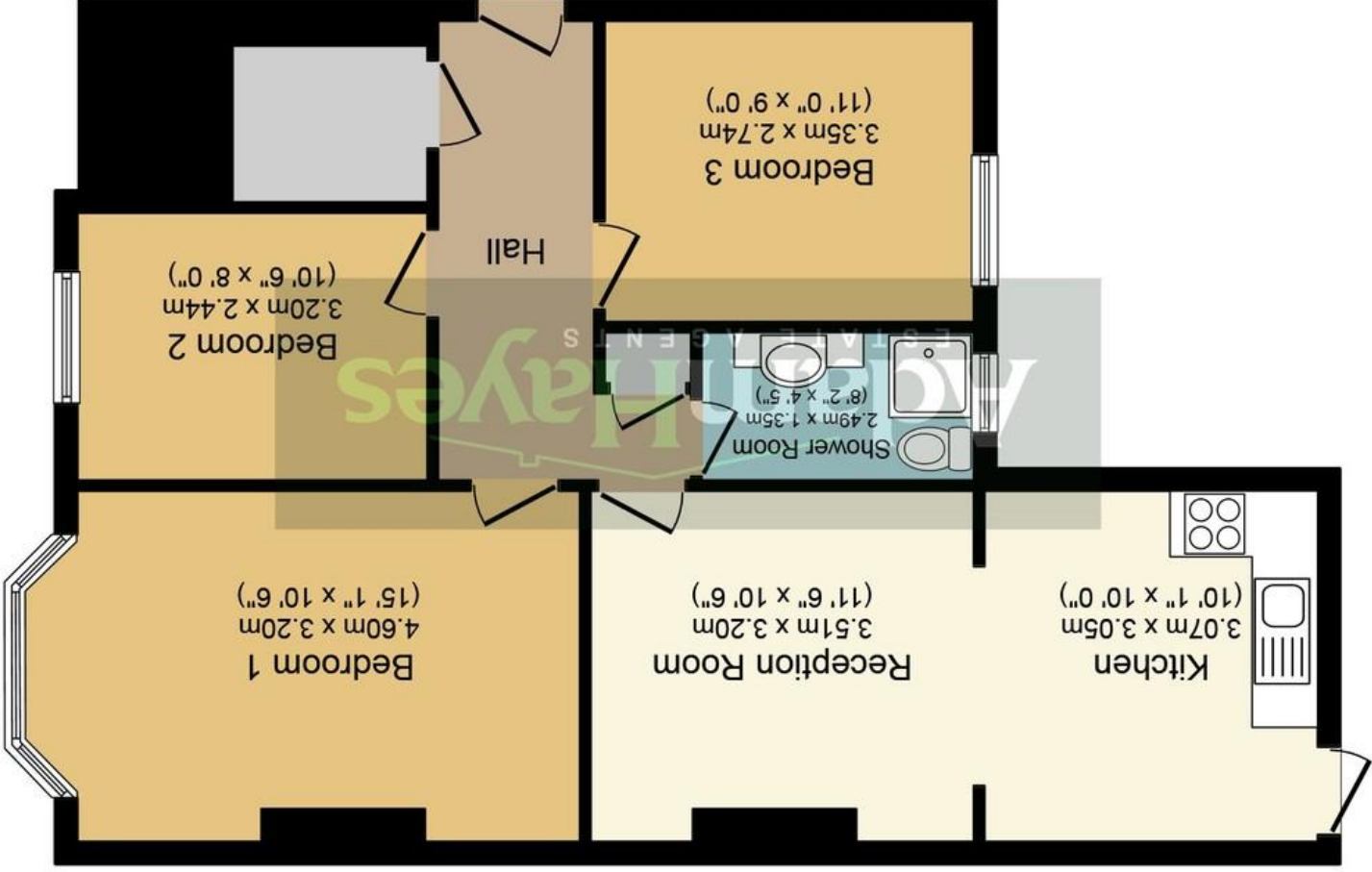

Floor Plan

Total floor area 72.0 sq. m. (775 sq. ft.) approx

This plan is for illustration purposes only and may not be representative of the property. Plan not to scale.

These particulars, whilst believed to be accurate are set out as a general outline only for guidance and do not constitute any part of an offer or contract. Intending purchasers should not rely on them as statements or representations or representations of fact, but must satisfy themselves by inspection or otherwise as to their accuracy. We have not carried out a detailed survey not tested the services, appliances and specific fittings. Room sizes should not be relied upon for carpets and furnishings. The measurements given are approximate. No person in this firm's employment has the authority to make or give any representation or warranty in respect of the property.